

YELLOWSTONE COUNTY BOARD OF COUNTY COMMISSIONERS

Resolution No. 24 - 99

**Resolution to Change Boundary Yellowstone County Rural Special Improvement District No. 715M
(Tanglewood Lake Estates Subdivision)**

WHEREAS, pursuant to Section 7-12-2161(4) of the Montana Code Annotated, a board of county commissioners can change boundaries of a rural special improvement once a year. The Montana Code Annotated does not specify the procedure a board should use to change the boundary of a district. When a property owner has not requested addition or removal from a district, to ensure the property owner has an opportunity to explain to the board why the property should be included or excluded from the district, a board should provide the property owner with notice of the board's intent to add or remove a property in the district and an opportunity to explain to the board why the property should not be added or removed from the district. The board should pass a resolution of intent to change boundary of the district, set a public hearing on the resolution, provide notice of the public hearing to the owner of the property to be added or excluded from the district, hold a public hearing, receive comments on the addition or removal of the property in the district and pass a resolution.

WHEREAS, the Yellowstone County Board of County Commissioners created Yellowstone County Rural Special Improvement District No. 715M to maintain the roads in Tanglewood Lake Estates Subdivision.

WHEREAS, on April 30, 2024, the Yellowstone County Board of County Commissioners passed a resolution of intent to change boundary for Yellowstone County Rural Special Improvement District No. 715M and set a public hearing on the boundary change for June 11, 2024. It has been determined that properties located within RSID 713M Tanglewood Lake Estates 2nd are encompassed within RSID 715M Tanglewood Lake Estates Subdivision. Therefore, these two districts shall be combined. In addition, there were properties within the current boundary of RSID 715M that are no longer a benefitted parcel due to alternate access via Wisner Ave. and should be removed from RSID No. 715M. On May 3, 2024, the Yellowstone County Clerk and Recorder mailed notice of the hearing to all property owners in the proposed boundary change of the District. On May 3, 2024 and May 10, 2024, the Yellowstone County Clerk and Recorder published notice of the public hearing in the *Yellowstone County News*. On June 11, 2024, the Board held a public hearing on the boundary change of the District. The Board heard comments on the boundary change of the District and considered protests as to the boundary change of the District. The Board did not receive enough protests to prevent the boundary change of the District. _____ out of 149 property owners protested the boundary change of the District. The Board believes the boundary change of the District is in the best interest of the public.

NOW THEREFORE, BE IT RESOLVED,

The Yellowstone County Board of County Commissioners will change the boundary of Yellowstone County Rural Special Improvement District 715M to maintain the roads in Tanglewood Lake Estates Subdivision to include parcels from former RSID 713M and to remove non-benefitted parcels. Attached as Exhibit A is a map showing the current boundary and the proposed boundary change. Attached as Exhibit B is a listing of current property owners and proposed property owners to be removed from the District. The change in assessment for the District will appear on the property owners' 2024 tax statements.

Passed and Adopted on the 11th day of June 2024.

BOARD OF COUNTY COMMISSIONERS, YELLOWSTONE COUNTY, MONTANA

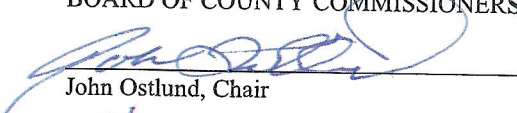
John Ostlund, Chair

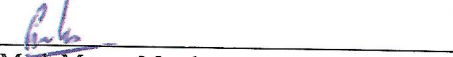
Mark Morse, Member

Donald W. Jones, Member

ATTEST:



Jeff Martin, Clerk and Recorder

Resolution No. 24 - 99

Resolution to Change Boundary Yellowstone County Rural Special Improvement District No. 715M

1 of 1

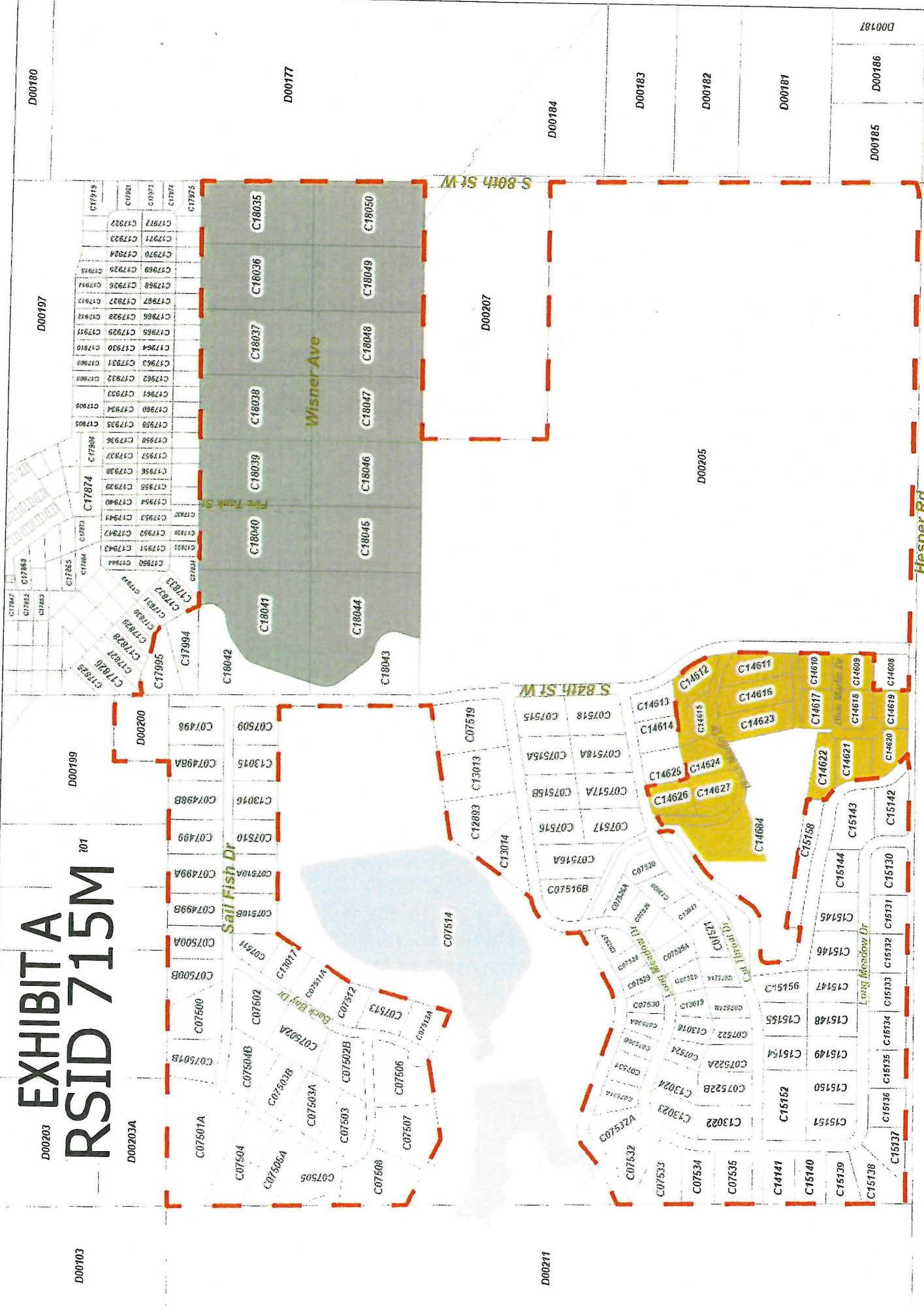
EXHIBIT A RSID 715M



- Original RSID 715M
- Proposed removal
- RSID 713M to be absorbed into 715M

EXHIBIT B
 RSID 7151M TANGLEWOOD LAKE ESTATES SUBDIVISION - PROPERTY LISTING
 FOR 2024 BOUNDARY CHANGE

TaxID	Owner_Name	FullAddr	MailAddr1	MailAddr2	City	ST	Zip	Legal Description
1	C07498 YERGER, KENDALL J.	8410 SAIL FISH DR	8410 SAIL FISH DR		BILLINGS	MT	59106-4614	TANGLEWOOD LAKES ESTATES 1ST, S14, T01 S, R24 E, BLOCK 1, Lot 1
2	C07498A TUELL, JAMES E & LORI K	8435 SAIL FISH DR	8435 SAIL FISH DR		BILLINGS	MT	59106-4618	TANGLEWOOD LAKES ESTATES 1ST, S14, T01 S, R24 E, & TANGLEWOOD WEST 1ST FILING AMND BLK 1 LOT 2
3	C07498B WIDDICOMBE, BREANNE N & SHAWN R	8465 SAIL FISH DR	8465 SAIL FISH DR		BILLINGS	MT	59106-4618	TANGLEWOOD LAKES ESTATES 1ST, S14, T01 S, R24 E, BLOCK 1, Lot 3
4	C07499 MOORE, EDWIN R.	8515 SAIL FISH DR	8515 SAIL FISH DR		BILLINGS	MT	59106-4615	TANGLEWOOD LAKES ESTATES 1ST, S14, T01 S, R24 E, BLOCK 1, Lot 3
5	C07499A CHARETTE, MELANIE	8535 SAIL FISH DR	8535 SAIL FISH DR		BILLINGS	MT	59106-4615	TANGLEWOOD LAKES ESTATES 1ST, S14, T01 S, R24 E, BLOCK 1, Lot 5
6	C07499B WALTER, LYNN M & KIM L	8545 SAIL FISH DR	8545 SAIL FISH DR		BILLINGS	MT	59106-4615	TANGLEWOOD LAKES ESTATES 1ST, S14, T01 S, R24 E, BLOCK 1, Lot 5
7	C07500 PHILIPPI, REBECCA L & CHAD D	8625 SAIL FISH DR	8625 SAIL FISH DR		BILLINGS	MT	59106-4601	TANGLEWOOD LAKES ESTATES 1ST, S14, T01 S, R24 E, BLOCK 1, Lot 6
8	C07500A SHEPP, PATRICK A & JESSICA L	8625 SAIL FISH DR	8625 SAIL FISH DR		BILLINGS	MT	59106-4615	TANGLEWOOD LAKES ESTATES 1ST, S14, T01 S, R24 E, BLOCK 1, Lot 9
9	C07500B LAMBERT, PAUL W III	8615 SAIL FISH DR	8615 SAIL FISH DR		BILLINGS	MT	59106-4626	TANGLEWOOD LAKES ESTATES 1ST, S14, T01 S, R24 E, BLOCK 1, Lot 7
10	C07501A BONNER, MATTHEW M & TIFFANY M	8705 SAIL FISH DR	8705 SAIL FISH DR		BILLINGS	MT	59106-4626	TANGLEWOOD LAKES ESTATES 1ST, S14, T01 S, R24 E, BLOCK 1, Lot 8
11	C07501B DAVID G KEIN TRUST &	8635 SAIL FISH DR	8635 SAIL FISH DR		BILLINGS	MT	59106-4603	TANGLEWOOD LAKES ESTATES 1ST, S14, T01 S, R24 E, BLOCK 1, Lot 11A, AMND **NOW COMBO LTS 8A & 11A, BLK 1** (16)
12	C07502 RUSSOM, TIMOTHY R & SHANNON L	1100 BACK BAY DR	1100 BACK BAY DR		BILLINGS	MT	59106-4603	TANGLEWOOD LAKES ESTATES 1ST, S14, T01 S, R24 E, BLOCK 1, Lot 10A, AMD 1.307 AC (07)
13	C07502A ROTTRUP, CADEN J & LAURA K	1110 BACK BAY DR	1110 BACK BAY DR		BILLINGS	MT	59106-4626	TANGLEWOOD LAKES ESTATES 1ST, S14, T01 S, R24 E, BLOCK 2, Lot 1
14	C07502B COWEN, MITCHELL E & AUCIA K	8770 SAIL FISH DR	8770 SAIL FISH DR		BILLINGS	MT	59106-4626	TANGLEWOOD LAKES ESTATES 1ST, S14, T01 S, R24 E, BLOCK 2, Lot 2
15	C07503 MORHAST, JEREMY & HEATHER	8766 SAIL FISH DR	8766 SAIL FISH DR		BILLINGS	MT	59106-4626	TANGLEWOOD LAKES ESTATES 1ST, S14, T01 S, R24 E, BLOCK 2, Lot 3
16	C07503A BECKHAM, NANCY	8730 SAIL FISH DR	8730 SAIL FISH DR		BILLINGS	MT	59103-3494	TANGLEWOOD LAKES ESTATES 1ST, S14, T01 S, R24 E, BLOCK 2, Lot 6A, AMD 1.239 AC (07)
17	C07503B BUNCH, TYSON &	8720 SAIL FISH DR	8720 SAIL FISH DR		BILLINGS	MT	59106-4626	TANGLEWOOD LAKES ESTATES 1ST, S14, T01 S, R24 E, BLOCK 2, Lot 6B, AMD 2.033 AC (07)
18	C07504 PENDERGRASS, DANIEL T & TANIA	8725 SAIL FISH DR	8725 SAIL FISH DR		BILLINGS	MT	59106-4626	TANGLEWOOD LAKES ESTATES 1ST, S14, T01 S, R24 E, BLOCK 2, Lot 7A, AMD 1.539 AC (07)
19	C07504B OTT, JUSTIN J & JESSICA	8710 SAIL FISH DR	8710 SAIL FISH DR		BILLINGS	MT	59106-4626	TANGLEWOOD LAKES ESTATES 1ST, S14, T01 S, R24 E, BLOCK 2, Lot 7B, AMD 1.539 AC (07)
20	C07505 BONINI ENTERPRISES LLC	SAIL FISH DR	8470 LONGMEADOW DR		BILLINGS	MT	59106-4626	TANGLEWOOD LAKES ESTATES 1ST, S14, T01 S, R24 E, BLOCK 2, Lot 10A, AMD 1.623 AC (07)
21	C07505A HARTMAN, EMANUEL W & LORNA R	8731 SAIL FISH DR	8731 SAIL FISH DR		BILLINGS	MT	59106-4614	TANGLEWOOD LAKES ESTATES 1ST, S14, T01 S, R24 E, BLOCK 3, Lot 1
22	C07506 MAURER, DANIEL P & JOELEN L	8775 SAIL FISH DR	8775 SAIL FISH DR		BILLINGS	MT	59106-4615	TANGLEWOOD LAKES ESTATES 1ST, S14, T01 S, R24 E, BLOCK 3, Lot 3A
23	C07507 MILLER, JAMES ADAM & SAMANTHA	8755 SAIL FISH DR	8755 SAIL FISH DR		BILLINGS	MT	59106-4615	TANGLEWOOD LAKES ESTATES 1ST, S14, T01 S, R24 E, BLOCK 4, Lot 1
24	C07508 HALE, MARK & MARGARET ANNE	8765 SAIL FISH DR	8765 SAIL FISH DR		BILLINGS	MT	59106-4626	TANGLEWOOD LAKES ESTATES 1ST, S14, T01 S, R24 E, BLOCK 4, Lot 4
25	C07509 LANDON, CHAD & HEATHER A	8420 SAIL FISH DR	8420 SAIL FISH DR		BILLINGS	MT	59106-4626	TANGLEWOOD LAKES ESTATES 1ST, S14, T01 S, R24 E, BLOCK 4, Lot 5
26	C07510 MURPHY, JERE	8520 SAIL FISH DR	8520 SAIL FISH DR		BILLINGS	MT	59102-2895	TANGLEWOOD LAKES ESTATES 1ST, S14, T01 S, R24 E, BLOCK 2, Lot 11A
27	C07510A POGHOSYAN, ASTGHK	8540 SAIL FISH DR	8540 SAIL FISH DR		BILLINGS	MT	59106-4626	TANGLEWOOD LAKES ESTATES 1ST, S14, T01 S, R24 E, BLOCK 2, Lot 10A, AMD 1.623 AC (07)
28	C07510B LYONS, ROBERT R & SHERY M	8550 SAIL FISH DR	8550 SAIL FISH DR		BILLINGS	MT	59106-4626	TANGLEWOOD LAKES ESTATES 1ST, S14, T01 S, R24 E, BLOCK 3, Lot 1
29	C07511 MORG, WILLARD L & JULIE A	1085 BACK BAY DR	1085 BACK BAY DR		BILLINGS	MT	59106-4614	TANGLEWOOD LAKES ESTATES 1ST, S14, T01 S, R24 E, BLOCK 3, Lot 2
30	C07511A LACKMAN, LUKE & DANIELLE M	1105 BACK BAY DR	1105 BACK BAY DR		BILLINGS	MT	59106-4615	TANGLEWOOD LAKES ESTATES 1ST, S14, T01 S, R24 E, BLOCK 3, Lot 3A
31	C07512 BEELER, SCOTT K	1115 BACK BAY DR	1115 BACK BAY DR		BILLINGS	MT	59106-4615	TANGLEWOOD LAKES ESTATES 1ST, S14, T01 S, R24 E, BLOCK 4, Lot 1
32	C07513 MCCOMISH DANIEL	1125 BACK BAY DR	1125 BACK BAY DR		BILLINGS	MT	59106-4630	TANGLEWOOD LAKES ESTATES 1ST, S14, T01 S, R24 E, BLOCK 4, Lot 5
33	C07513A PAVIA, NICHOLAS M & JACQUELINE R	1135 BACK BAY DR	1135 BACK BAY DR		BILLINGS	MT	59106-4630	TANGLEWOOD LAKES ESTATES 1ST, S14, T01 S, R24 E, BLOCK 4, Lot 6
34	C07515 FISCHER, CLAYTON A &	8410 LONGMEADOW DR	8410 LONGMEADOW DR		BILLINGS	MT	59106-4603	TANGLEWOOD LAKES ESTATES 1ST, S14, T01 S, R24 E, BLOCK 4, Lot 10
35	C07515A BONINI ENTERPRISES LLC	LONGMEADOW DR	8470 LONGMEADOW DR		BILLINGS	MT	59106-4603	TANGLEWOOD LAKES ESTATES 1ST, S14, T01 S, R24 E, BLOCK 4, Lot 11
36	C07515B BONINI, JOE & SHAWNA	8470 LONGMEADOW DR	8470 LONGMEADOW DR		BILLINGS	MT	59106-4613	TANGLEWOOD LAKES ESTATES 1ST, S14, T01 S, R24 E, BLOCK 4, Lot 12
37	C07516 ALBRECHT, NICHOLAS JAY & JEANETTE	8510 LONG MEADOW DR	8510 LONG MEADOW DR		BILLINGS	MT	59106-4813	TANGLEWOOD LAKES ESTATES 1ST, S14, T01 S, R24 E, BLOCK 10, Lot 1
38	C07516A BLOCK, DANA & DANIA	8520 LONGMEADOW DR	8520 LONGMEADOW DR		BILLINGS	MT	59106-1826	TANGLEWOOD LAKES ESTATES 1ST, S14, T01 S, R24 E, BLOCK 10, Lot 3
39	C07516B LEONIS, DOMINGO &	8530 LONGMEADOW DR	8530 LONGMEADOW DR		BILLINGS	MT	59106-1826	TANGLEWOOD LAKES ESTATES 1ST, S14, T01 S, R24 E, BLOCK 10, Lot 4
40	C07517 HILLIS, DAVID G & AIMEE	8505 CUT THROAT DR	8505 CUT THROAT DR		BILLINGS	MT	59106-4613	TANGLEWOOD LAKES ESTATES 1ST, S14, T01 S, R24 E, BLOCK 10, Lot 5
41	C07517A SULLIVAN, BRADLEY ION & LORIE ANN	8445 CUT THROAT DR	8445 CUT THROAT DR		BILLINGS	MT	59106-4611	TANGLEWOOD LAKES ESTATES 1ST, S14, T01 S, R24 E, BLOCK 10, Lot 6
42	C07518 MCELLOD, JENNIFER	8405 CUT THROAT DR	8405 CUT THROAT DR		BILLINGS	MT	59106-4611	TANGLEWOOD LAKES ESTATES 1ST, S14, T01 S, R24 E, BLOCK 10, Lot 7
43	C07518A PELLA-FROHLICH, BARBARA C &	8425 CUT THROAT DR	8425 CUT THROAT DR		BILLINGS	MT	59106-4611	TANGLEWOOD LAKES ESTATES 1ST, S14, T01 S, R24 E, BLOCK 10, Lot 8
44	C07519 KAMTA, JOEJ TRUSTEE	8405 LONGMEADOW DR	8405 LONGMEADOW DR		BILLINGS	MT	59106-4613	TANGLEWOOD LAKES ESTATES 1ST, S14, T01 S, R24 E, BLOCK 10, Lot 10
45	C07520 PERRIGO, COLE & BRITTNEY	8525 CUT THROAT DR	8525 CUT THROAT DR		BILLINGS	MT	59106-1813	TANGLEWOOD LAKES ESTATES 1ST, S14, T01 S, R24 E, BLOCK 11, Lot 1
46	C07521 MORGAN, TWILLA KAY	8575 CUT THROAT DR	8575 CUT THROAT DR		BILLINGS	MT	59106-1813	TANGLEWOOD LAKES ESTATES 1ST, S14, T01 S, R24 E, BLOCK 11, Lot 1
47	C07521A DOYLE, JEFFREY L & KARLA	8605 CUT THROAT DR	8605 CUT THROAT DR		BILLINGS	MT	59106-1813	TANGLEWOOD LAKES ESTATES 1ST, S14, T01 S, R24 E, BLOCK 11, Lot 1
48	C07521B KAHN, CHRISTOPHER M & SUSAN M	8625 CUT THROAT DR	8625 CUT THROAT DR		BILLINGS	MT	59106-4617	TANGLEWOOD LAKES ESTATES 1ST, S14, T01 S, R24 E, BLOCK 14, Lot 1
49	C07522 RATH, MADINE	8625 CUT THROAT DR	8625 CUT THROAT DR		BILLINGS	MT	59106-4617	TANGLEWOOD LAKES ESTATES 1ST, S14, T01 S, R24 E, BLOCK 14, Lot 5
50	C07522A SNYDER, SHAWN	8705 CUT THROAT DR	8705 CUT THROAT DR		BILLINGS	MT	59106-4617	TANGLEWOOD LAKES ESTATES 1ST, S14, T01 S, R24 E, BLOCK 14, Lot 6
51	C07522B SITTER, GAYLE & DIANE	8665 CUT THROAT DR	8665 CUT THROAT DR		BILLINGS	MT	59106-4617	TANGLEWOOD LAKES ESTATES 1ST, S14, T01 S, R24 E, BLOCK 14, Lot 7
52	C07524 PALMITER, SAMUEL R & SONYA L	8705 CUT THROAT DR	8705 CUT THROAT DR		BILLINGS	MT	59106-4621	TANGLEWOOD LAKES ESTATES 1ST, S14, T01 S, R24 E, BLOCK 14, Lot 8
53	C07525 REIGER, LISA	8660 LONGMEADOW DR	8660 LONGMEADOW DR		BILLINGS	MT	59106-1802	TANGLEWOOD LAKES ESTATES 1ST, S14, T01 S, R24 E, BLOCK 14, Lot 8
54	C07525A WILLIAMS, THOMAS T & DARLENE M	8610 LONGMEADOW DR	8610 LONGMEADOW DR		BILLINGS	MT	59106-1802	TANGLEWOOD LAKES ESTATES 1ST, S14, T01 S, R24 E, BLOCK 14, Lot 13
55	C07525B SCHAFF, LESTER C & DONNA WILSON	8590 LONGMEADOW DR	8590 LONGMEADOW DR		BILLINGS	MT	59106-1826	TANGLEWOOD LAKES ESTATES 1ST, S14, T01 S, R24 E, BLOCK 14, Lot 16
56	C07526 WALTON, AMY J & DONAVON	8580 LONGMEADOW DR	8580 LONGMEADOW DR		BILLINGS	MT	59106-1826	TANGLEWOOD LAKES ESTATES 1ST, S14, T01 S, R24 E, BLOCK 14, Lot 17
57	C07526A SONGSTAD, JOHN & ALLYSON	8570 LONGMEADOW DR	8570 LONGMEADOW DR		BILLINGS	MT	59106-1826	TANGLEWOOD LAKES ESTATES 1ST, S14, T01 S, R24 E, BLOCK 14, Lot 18
58	C07527 WEAVER, NATHAN D & REBECA	8560 LONGMEADOW DR	8560 LONGMEADOW DR		BILLINGS	MT	59106-1826	TANGLEWOOD LAKES ESTATES 1ST, S14, T01 S, R24 E, BLOCK 14, Lot 19
59	C07528 BOUCHARD, RICK & MARTHA	8577 LONGMEADOW DR	8577 LONGMEADOW DR		BILLINGS	MT	59106-1825	TANGLEWOOD LAKES ESTATES 1ST, S14, T01 S, R24 E, BLOCK 14, Lot 20
60	C07529 EIDE, JEREMY J & MARY F	8605 LONGMEADOW DR	8605 LONGMEADOW DR		BILLINGS	MT	59106-1825	TANGLEWOOD LAKES ESTATES 1ST, S14, T01 S, R24 E, BLOCK 15, Lot 1
61	C07530 DAINTIC, AARON J & UNDISSEY	8625 LONGMEADOW DR	8625 LONGMEADOW DR		BILLINGS	MT	59106-1823	TANGLEWOOD LAKES ESTATES 1ST, S14, T01 S, R24 E, BLOCK 15, Lot 2
62	C07530A JAMISON, ZACHERY W & JULIE M	8635 LONGMEADOW DR	8635 LONGMEADOW DR		BILLINGS	MT	59106-1823	TANGLEWOOD LAKES ESTATES 1ST, S14, T01 S, R24 E, BLOCK 15, Lot 4
63	C07530B LWJE, NICHOLAS & CHRISTINE	8655 LONGMEADOW DR	8655 LONGMEADOW DR		BILLINGS	MT	59106-1823	TANGLEWOOD LAKES ESTATES 1ST, S14, T01 S, R24 E, BLOCK 15, Lot 5
64	C07531 MILL, KIMBERLY A	8705 LONGMEADOW DR	8705 LONGMEADOW DR		BILLINGS	MT	59106-4606	TANGLEWOOD LAKES ESTATES 1ST, S14, T01 S, R24 E, BLOCK 15, Lot 6
65	C07531A NEW LIFE PROPERTIES LLC	8715 LONGMEADOW DR	8715 LONGMEADOW DR		CLOVIS	NM	88102-5711	TANGLEWOOD LAKES ESTATES 1ST, S14, T01 S, R24 E, BLOCK 15, Lot 7

EXHIBIT B
RSID 715W TANGLEWOOD LAKE ESTATES SUBDIVISION - PROPERTY LISTING
FOR 2024 BOUNDARY CHANGE

Parcel ID	Owner	Address	Property Description	Notes
66 C07532	MAPSTON, KELLY J & TWILA J	8735 LONGMEADOW DR	BILLINGS	
67 C07532A	MAPSTON, KELLY J & TWILA J	8735 LONGMEADOW DR	BILLINGS	
68 C07533	LINTON, MATTHEW & BETHANY	8745 LONGMEADOW DR	BILLINGS	
69 C07534	BOWEN, RICHARD LEE	8755 LONGMEADOW DR	BILLINGS	
70 C07535	STOVALL, JEFFREY	8765 LONGMEADOW DR	BILLINGS	
71 C12893	HARPER, SHANNON D & JULIE K	8485 LONGMEADOW DR	BILLINGS	
72 C13013	KRUG, DARCI	8455 LONGMEADOW DR	BILLINGS	
73 C13014	WALTON, MELISSA C & WILLIAM A	8515 LONGMEADOW DR	BILLINGS	
74 C13015	MOORMAN, MICHAEL W & DONNA M	8440 SAIL FISH DR	BILLINGS	
75 C13016	OLSON, JUDITH ANN	8470 SAIL FISH DR	BILLINGS	
76 C13017	WINK, KYLE & ABBEY	1095 BACK BAY DR	BILLINGS	
77 C13018	NASH, KARRI	8650 LONGMEADOW DR	BILLINGS	
78 C13019	TOUNSEY, CIP L	8630 LONGMEADOW DR	BILLINGS	
79 C13020	WYMAN, SEAN	8535 CUT THROAT DR	BILLINGS	
80 C13021	ROCKWELL, KEVIN & CHRISTINA	8545 CUT THROAT DR	BILLINGS	
81 C13022	SMITH, GARY P &	8725 CUT THROAT DR	BILLINGS	
82 C13023	LEINIZ, JESSICA E & CHRISTOPHER A	8740 LONGMEADOW DR	BILLINGS	
83 C13024	MILL, KIMBERLY A (1/2 INT) &	LONGMEADOW DR	BILLINGS	
84 C14141	PATTERSON, BARRY E & DEBBIE	8805 LONGMEADOW DR	BILLINGS	
85 C14608	ZUMBRUN, ANGIE J	1580 S 84TH ST W	BILLINGS	
86 C14613	JAMES, KENNETH A & CONSUELA M	8400 CUT THROAT DR	BILLINGS	
87 C14614	REIMERS, PHILLIP M & MARIA A	8420 CUT THROAT DR	BILLINGS	
88 C14625	BROBERG, DANNY	8440 CUT THROAT DR	BILLINGS	
89 C15130	LOVE, ROSS D	8955 LONGMEADOW DR	BILLINGS	
90 C15131	FELLOWS, JAMIE	8945 LONGMEADOW DR	BILLINGS	
91 C15132	LOPEMAN, ANDREW D	8935 LONGMEADOW DR	BILLINGS	
92 C15133	MURRAY, DEAN MICHAEL & CHDY L	8925 LONGMEADOW DR	BILLINGS	
93 C15134	FINN, DOUGLAS E & MICHELE R	8915 LONGMEADOW DR	BILLINGS	
94 C15135	ADAMS, WANDA K ETAL	8905 LONGMEADOW DR	BILLINGS	
95 C15136	BELL, ALISSA &	8855 LONGMEADOW DR	BILLINGS	
96 C15137	NYMEYER, KEVIN W & SHELLEY D	8835 LONGMEADOW DR	BILLINGS	
97 C15138	CARDER, DEVIN	8812 CENTRAL AVE	BILLINGS	
98 C15139	CARDER, DEVIN	8835 LONGMEADOW DR	BILLINGS	
99 C15140	ALBRECHT, JEANETTE	812 CENTRAL AVE	BILLINGS	
100 C15142	PEPOS, ZANE C & JESSICA L	8980 LONGMEADOW DR	BILLINGS	
101 C15143	NIJBERGER, COLLEEN M & HOWARD P	8970 LONGMEADOW DR	BILLINGS	
102 C15144	PARENT, ALLEN	8960 LONGMEADOW DR	BILLINGS	
103 C15145	CHASE, MONICA	8950 LONGMEADOW DR	BILLINGS	
104 C15146	WETZLER, LANCE W & LISA M	8940 LONGMEADOW DR	BILLINGS	
105 C15147	ENTOSH, JOSH &	8930 LONGMEADOW DR	BILLINGS	
106 C15148	SCHREINER, ALAN D & TAMMY S	8920 LONGMEADOW DR	BILLINGS	
107 C15149	JOHNSON, LORI &	8910 LONGMEADOW DR	BILLINGS	
108 C15150	SPENCER, AVERY & AMANDA	8900 LONGMEADOW DR	BILLINGS	
109 C15151	BONINI ENTERPRISES LLC	8830 LONGMEADOW DR	BILLINGS	
110 C15152	BOWMAN, MASON R & KIMBERLY L	8710 CUT THROAT DR	BILLINGS	
111 C15154	RIWAL-COUCH, JOSHUA & CARA	8660 CUT THROAT DR	BILLINGS	
112 C15155	GOATES, SEAN	8630 CUT THROAT DR	BILLINGS	
113 C15156	BROWN, MARVIN J	8610 CUT THROAT DR	BILLINGS	
114 C17994	TRIMBLE, STEVEN L & BLUNDA A	945 S 84TH ST W	BILLINGS	
115 C17995	WATSON, RICHARD A & KRISTAL J	941 S 84TH ST W	BILLINGS	
116 C18042	ELSER FAMILY TRUST	977 S 84TH ST W	BILLINGS	
117 C18043	ROGERS, SANDY F	1103 S 84TH ST W	BILLINGS	
118 D00200	PALIN, WALTER D	948 S 84TH ST W	BILLINGS	
119 D00205	WOODS, JOHN JR (1/3 INT)	3521 TOMMY ARMOUR CIR	BILLINGS	
To be added (from RSID 713M):				
1	C14609	BLODGETT, DUSTIN & HANNAH	8410 BLUE MARLIN DR	
2	C14610	HOPKINS, CODY C & AUBREY L	17 1/2 ALDERSON AVE	
3	C14611	GORDER, CHRISTIAN A & KATHLEEN G	8400 BLACK MARLIN DR	
4	C14612	ANDERSON, RACHEL D	8401 BLACK MARLIN DR	
5	C14615	GRAY, GERALD	8415 BLACK MARLIN	
6	C14616	BACH, RODDO S & SHELBY E	8410 BLACK MARLIN DR	
7	C14617	HOPKINS, CODY C & AUBREY L	BLUE MARLIN DR	
8	C14618	HEREIM, CHARLES E & JEANNE	17 1/2 ALDERSON AVE	
9	C14619	ZUNDEL, RON D	1335 BLUE MARLIN DR	
10	C14620	ELK CREEK LLP	1545 BLUE MARLIN CT	
			1545 BLUE MARLIN DR	

EXHIBIT B
 RS/D 715M TANGLEWOOD LAKE ESTATES SUBDIVISION - PROPERTY LISTING
 FOR 2024 BOUNDARY CHANGE

Parcel ID	Owner	Address	Legal Description	Notes
11	C14621	MCDONALD, TOM J & STEPHANIE L	1530 BLUE MARLIN DR	MT 59106-4624 TANGLEWOOD LAKES ESTATES 2ND, S14, T01 S, R24 E, BLOCK 9, Lot 14
12	C14622	YEAGER, DEREK	1520 BLUE MARLIN DR	MT 59106-4624 TANGLEWOOD LAKES ESTATES 2ND, S14, T01 S, R24 E, BLOCK 9, Lot 15
13	C14623	ROSE, DARYL L	8420 BLACK MARLIN DR	MT 59106-4622 TANGLEWOOD LAKES ESTATES 2ND, S14, T01 S, R24 E, BLOCK 9, Lot 16
14	C14624	PATTERSON, SHANNAN STUART &	8435 BLACK MARLIN DR	MT 59106-4622 TANGLEWOOD LAKES ESTATES 2ND, S14, T01 S, R24 E, BLOCK 9, Lot 17
15	C14625	SAMANO, GREGORY P & MARGARET M	925 CHINABERRY CT	NEW SMYRNA BE FL 32166-7941 TANGLEWOOD LAKES ESTATES 2ND, S14, T01 S, R24 E, BLOCK 9, Lot 19
16	C14627	WERBELOW, RICHARD & LINDA J	8455 BLACK MARLIN DR	MT 59106-4622 TANGLEWOOD LAKES ESTATES 2ND, S14, T01 S, R24 E, BLOCK 9, Lot 20
<hr/>				
135 Total Parcels after boundary change June 2024				
To be removed:				
1	C18035	NAZARIAN, JOHN JAMES &	8039 WISNER AVE	MT 59106-4648 HOMESTEAD ACRES SUB (21), S14, T01 S, R24 E, Lot 1
2	C18036	NAZARIAN, JOHN JAMES	8111 WISNER AVE	MT 59106-4648 HOMESTEAD ACRES SUB (21), S14, T01 S, R24 E, Lot 2
3	C18037	LAS PALMAS LLC	49660 HAMMER DAM RD	MT 59864-9448 HOMESTEAD ACRES SUB (21), S14, T01 S, R24 E, Lot 3
4	C18038	DELAWARE, JUSTIN & IMONICA	PO BOX 81368	MT 59106-1368 HOMESTEAD ACRES SUB (21), S14, T01 S, R24 E, Lot 4
5	C18039	LAS PALMAS LLC	5501 CANVASSACK DR	MT 59106-3748 HOMESTEAD ACRES SUB (21), S14, T01 S, R24 E, Lot 5
6	C18040	LAS PALMAS LLC	610 S 44TH ST W APT 2304	MT 59106-3951 HOMESTEAD ACRES SUB (21), S14, T01 S, R24 E, Lot 6
7	C18041	STANLEY, DENISE	49 ORCHARD LN	MT 59101-4910 HOMESTEAD ACRES SUB (21), S14, T01 S, R24 E, Lot 7
8	C18044	LAS PALMAS, LLC	C/O ROBERT H & KATIE V BOYCE	MT 59102-5564 HOMESTEAD ACRES SUB (21), S14, T01 S, R24 E, Lot 10
9	C18045	CLARK, SCOTT O & MARY L	8220 WISNER AVE	MT 59859-9380 HOMESTEAD ACRES SUB (21), S14, T01 S, R24 E, Lot 11
10	C18046	LAS PALMAS LLC	3 HELTERLINE RD	MT 59106-3942 HOMESTEAD ACRES SUB (21), S14, T01 S, R24 E, Lot 12
11	C18047	DAIGNEAU II, ALLAN &	610 S 44TH ST W APT 4201	MT 59106-4647 HOMESTEAD ACRES SUB (21), S14, T01 S, R24 E, Lot 13
12	C18048	ZIMMERMAN, SHAWN &	8112 WISNER AVE	MT 59105-3332 HOMESTEAD ACRES SUB (21), S14, T01 S, R24 E, Lot 14
13	C18049	MCKAMEY, BRANDON & KRISTAL	704 JOYCE ST	MT 59106-4648 HOMESTEAD ACRES SUB (21), S14, T01 S, R24 E, Lot 15
14	C18050	STANEK, JON E & REBEKAH A	8018 WISNER AVE	MT 59106-4648 HOMESTEAD ACRES SUB (21), S14, T01 S, R24 E, Lot 16
Private Parks - not assessed:				
1	C14694	LAKESIDE HOMEOWNERS ASSOCIATION	8535 LONGMEADOW DR	MT 59106-1825 TANGLEWOOD LAKES ESTATES 2ND, S14, T01 S, R24 E, BLOCK 9, Lot 23, AMD (15)
2	C15157	LAKESIDE HOMEOWNERS ASSOCIATION	8535 LONGMEADOW DR	MT 59106-1825 TANGLEWOOD LAKES ESTATES 3RD, S14, T01 S, R24 E, BLOCK 13, Lot 16, .
3	C15158	LAKESIDE HOMEOWNERS ASSN	8535 LONGMEADOW DR	MT 59106-1825 TANGLEWOOD LAKES ESTATES 3RD, S14, T01 S, R24 E, BLOCK 9, Lot 24

**Affidavit of Publication and Mailing of Notice of Hearing
On Proposed Boundary Change of Yellowstone County Rural Special Improvement District No 715M
(Tanglewood Lake Estates Subdivision)**

STATE OF MONTANA)
 : ss.
County of Yellowstone)

Jeff Martin, being first duly sworn, deposes and says:

I am the Yellowstone County Clerk and Recorder. I am the Secretary for the Yellowstone County Board of County Commissioners. On April 30, 2024, the Board passed a resolution of intent to change boundary of Yellowstone County Rural Special Improvement District No. 715M that maintains the roads in the Tanglewood Lake Estates Subdivision. It set a public hearing on the proposed boundary change of the District for June 11, 2024 and ordered me to publish notice of the public hearing, mail notice of the public hearing to all property owners within the proposed boundary change of the District, receive written comments and protests on the boundary change and provide the comments and protests to the Board before the hearing. In compliance with the order, on May 3, 2024 and May 10, 2024, I published notice of the public hearing in the *Yellowstone County News*. Attached is a copy of the notice published in the *Yellowstone County News*. On May 3, 2024, I mailed notice of the public hearing to all the property owners within the proposed boundary change of the District. Attached is the list of property owners I sent the notice to and the notice I sent. I received 4 comments and 4 protests on the boundary change of the District. I provided the comments and protests to the Board prior to the hearing.

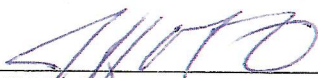

Jeff Martin
Yellowstone County Clerk and Recorder

SUBSCRIBED AND SWORN to before me this 11th day of June 2024.

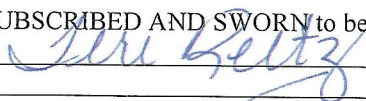

Notary Public for the State of Montana
Residing at Billings, Montana.
My commission expires _____

(Notarial Seal)

